

SOLD

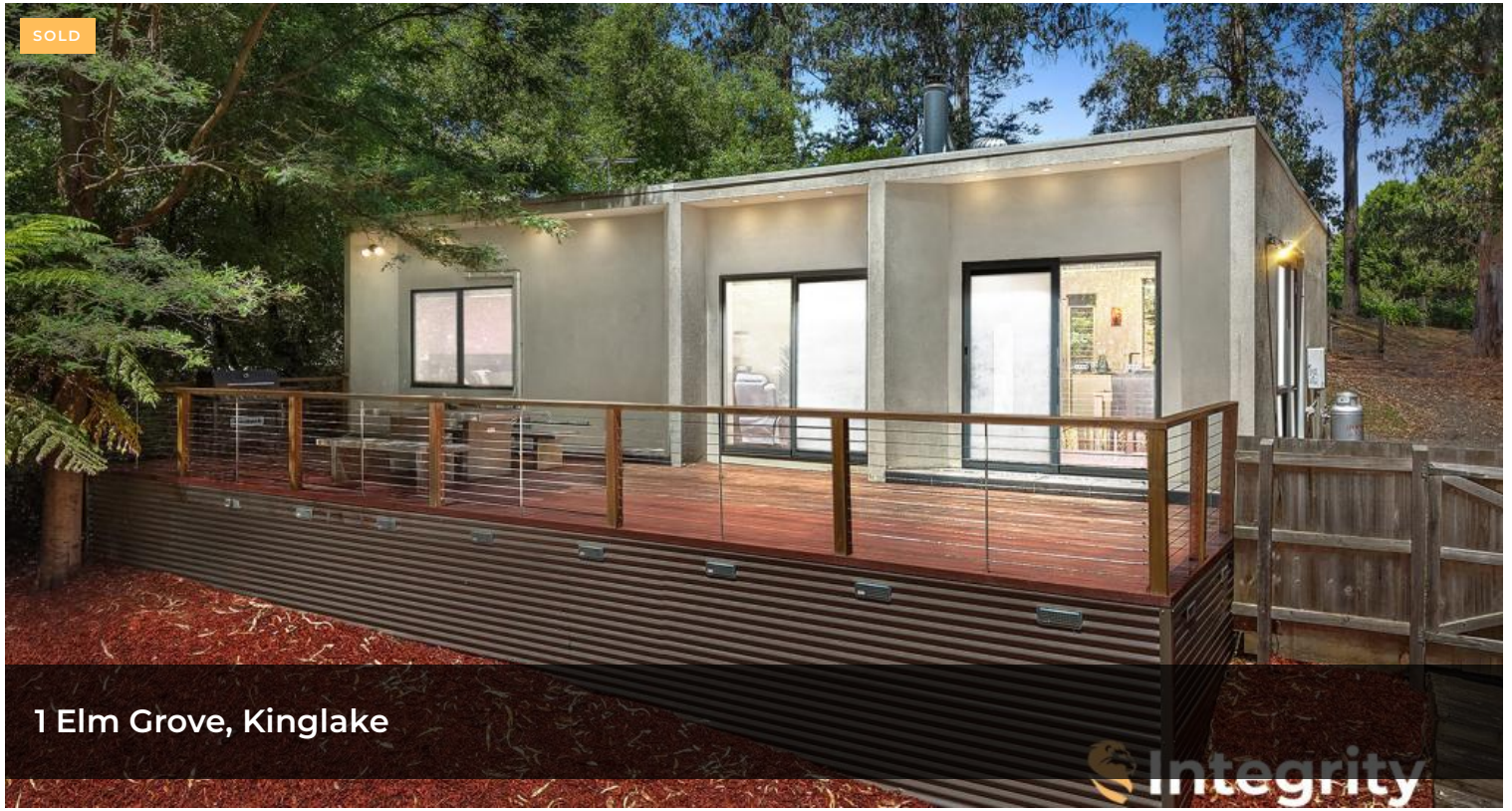

1 Elm Grove, Kinglake



Perfect First Home on 1968sqm

Situated right in the heart of the Kinglake township is this perfect first home. A stylish modern residence with all the modern conveniences. A near half an acre allotment backing onto the Number One Creek makes this a very tranquil spot.

Step inside and you'll find 2 bedrooms, large bathroom and open plan kitchen living dining. You're all set with the ambience of wood heating and split system reverse cycle air conditioning. Other features include quality appliances and stone bench tops in the kitchen, built in robes to all bedrooms, LED lighting and Fibre Internet.

Outside you'll find a generous entertainment decking overlooking the leafy surrounds with a path leading to the firepit area and the creek.

You're just a short stroll from Kinglake Township, Bollygum Park, and all essential amenities. Imagine weekends filled with

🏠 2 🛏 1 📏 1,968 m²

Price SOLD for \$531,000

Property Type Residential

Property ID 579

Land Area 1,968 m²

Agent Details

William Verhagen - 0437 371 969

Office Details

Integrity Real Estate - Yarra Glen

SHOP 2 38-40 Bell St Yarra Glen, VIC, 3775 Australia
03 9730 2333

outdoor adventures and tranquil moments with family and friends. Perfectly suited for recreational activities, this property gives you direct access to the breathtaking beauty and endless exploration opportunities of the Kinglake Ranges. Book your inspection today.

Integrity

Yarra Valley & Kinglake Ranges

The above information provided has been furnished to us by the vendor/s. We have not verified whether or not that information is accurate and do not have any belief in one way or the other in its accuracy. We do not accept any responsibility to any person for its accuracy and do no more than pass it on. All interested parties should make and rely upon their own inquiries in order to determine whether or not this information is in fact accurate.